

Instructions Manual

Folding Kayak
NERIS ALU-1 (transformer)



1. General description



NERIS Alu-1 is a touring folding kayak ideal for flat water trips on rivers, lakes and reservoirs. The kayak may also be suitable for sea and ocean kayaking along the shore line. The light weight and compact size are the main advantages of the NERIS Alu-1 folding kayak providing paddlers ease in transporting and usage. The kayak assembly or disassembly time is within 20-25 minutes. No additional tools are required. The frame of the kayak provides the required stiffness and shape to provide a great paddling experience.

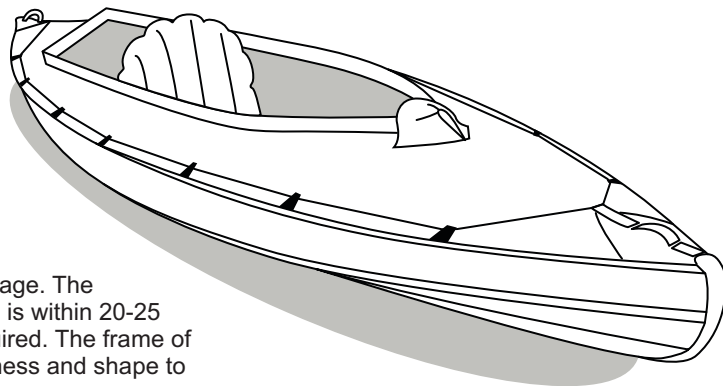

Technical specifications:

Loading capacity	150 kg
Length	4,0 m
Width	0,79 m
Weight	19 kg

Packaging size:

Backpack (mm) 430 x 230 x 1100

Number of passengers:

1 adult or 1 adult + 1 child



Be sure to use parts with same colour markers on the frame pieces during assembly. Different colour signs indicate respective models of "Alu" kayaks.

2. Kayak backpack contents

1. Set of Cross Ribs - 3 pcs - Bow, Central and Stern
2. Bow and Stern Assembly (End posts)
3. Bow and Stern A-Shape Keel Bars
4. Set of pole stringers
 - Long stringers - 6 pcs
 - Short stringers - 6 pcs
 - Short stringers with sliding latches - 6 pcs
5. Set of Washboards - 4 pcs
6. Boomerang
7. Skin
8. Foot rest
9. Seat
10. Repair Kit

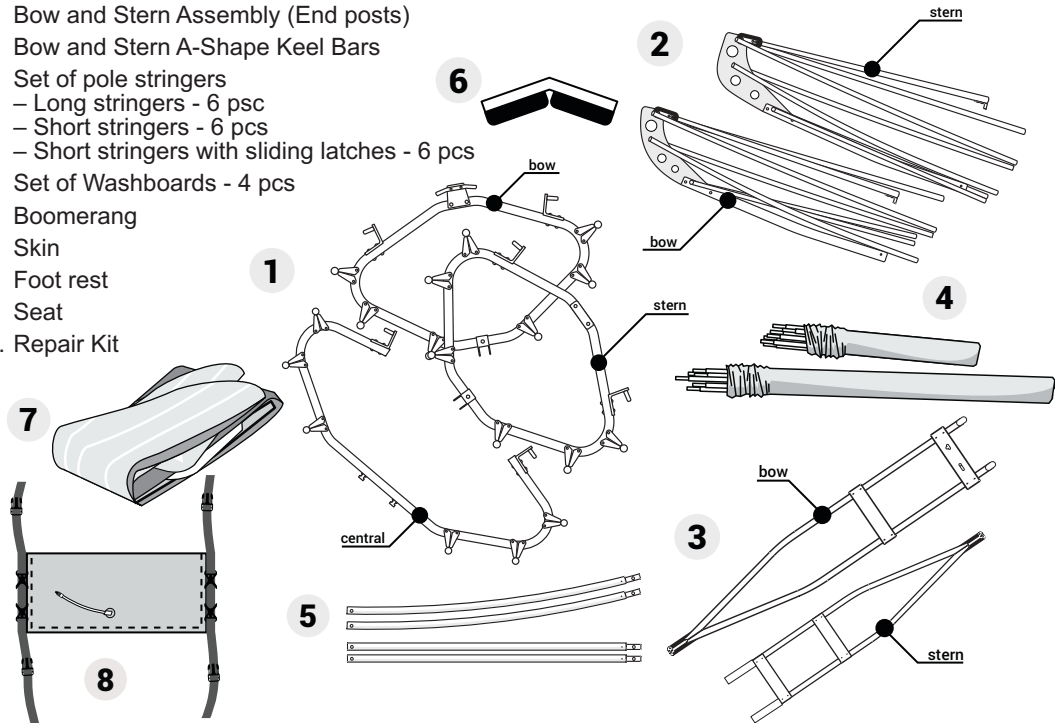

3.Assembly Instructions



All NERIS folding kayaks are checked with a presale test assembly. The first kayak assembly that you do may seem to be more challenging at first. The skin will become stretched with each subsequent assembly and hence it will become easier to put the skin on the frame. The kayak ideally should be assembled on even and clean surface. Avoid assembling the kayak frame on sand, which may cause damage to the frame joints making future assembly and disassembly more difficult in future. Sand between the skin and frame also causes abrasion.

The main parts of the kayak are marked with numbers and arrows for ease of assembly. The Keel Bars are marked showing points where the Cross Ribs are to be installed.

Step 1

Join the Bow and Stern A-frame Keel Bars to the respective Bow and Stern Assemblies. Attach Cross Rib #1 and #3 to the respective Bow and Stern Assembly, using the supplied wing nuts and bolts to secure the cross rib to the keel. The cross ribs have stainless steel brackets used to hold the pole stringers - note that the pole stringer brackets on Cross Rib #1 must slope towards the bow. The brackets on Cross Rib #3 must slope towards the stern. The Bow and Stern Assemblies have a central topmost pole stringer called the Deck Ridge Bar. These Deck Ridge Bars hook onto the catch affixed on the top of the cross ribs.

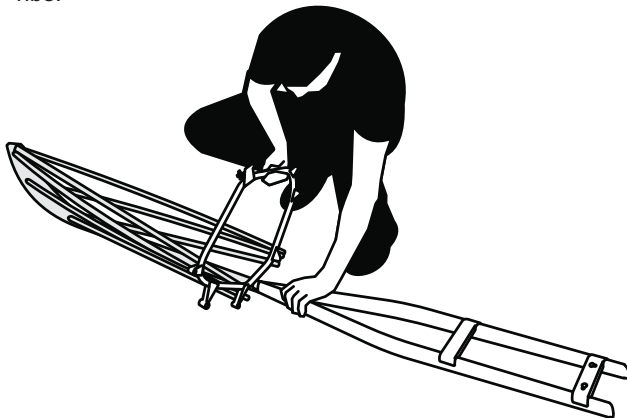

3. Assembly Instructions

Step 2

Position pole stringers (female) of the Bow Assembly next to the respective cross rib pole stringer brackets on the Cross Rib#1. Fully insert the male end of the long pole stringers one by one through the cross rib brackets. Repeat this step for attaching the short pole stringers (without sliding latches) to the Stern Assembly. The bow and stern sections are ready to be inserted into the skin.

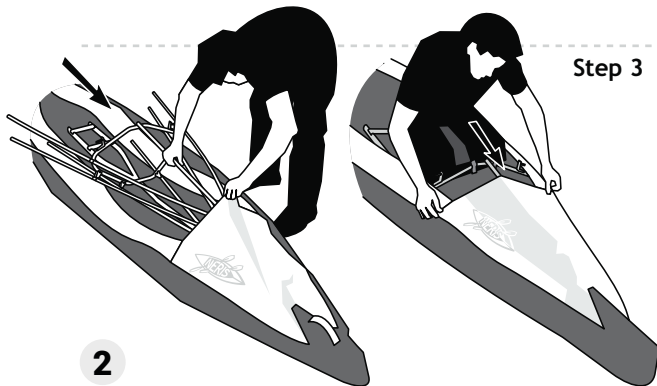
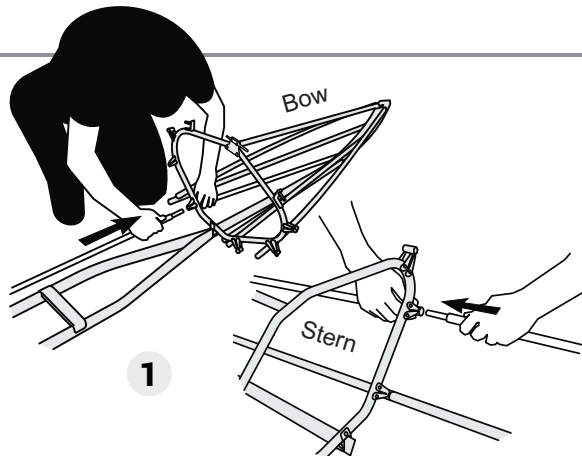

Step 3

Unroll the skin. Insert bow and stern assembly sections into the skin (The NERIS logo and rudder hanger bracket is located at the stern of the skin for easy reference). Make sure that the stitch line between deck and hull is positioned just above the upper pole stringers (fold is upwards). Avoid possible lop-sided insertion of the bow and stern frame sections whilst sliding the frame into the skin. Use the weld marks on the floor of the hull and the upper alu deck ridge bar as centring references. Push the frame halves as far into the skin as possible.

3.Assembly Instructions

Step 4

1. Lift the middle parts of bow and stern frame sections, making sure that the side pole stringers are not caught under the PVC fabric. Join the Keel Bar male and female pieces together and slowly push the Keel Bars down to the floor. This procedure is important to ensure the proper secured Keel Bar structure and to stretch the skin lengthwise.

2. Install Cross Rib #2. Insert one of the lower cross rib pins into the keyhole slot on the keel bar plate (keyhole is parallel to the plate). Whilst lifting slightly, rotate the Cross Rib and position the second pin into the second keyhole slot (right angled to the plate). Insert this second pin and twist the Cross-Rib to keep both pins securely in place.

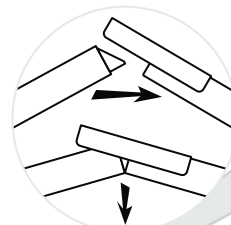
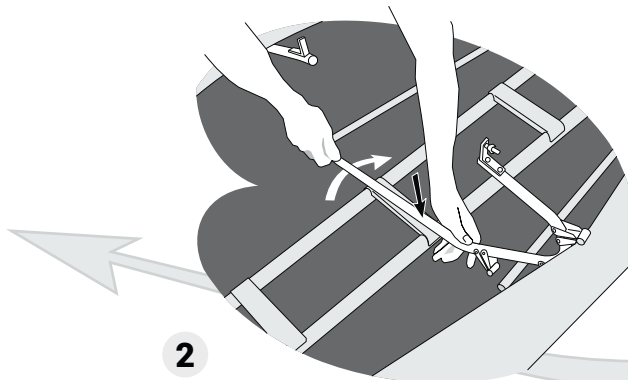
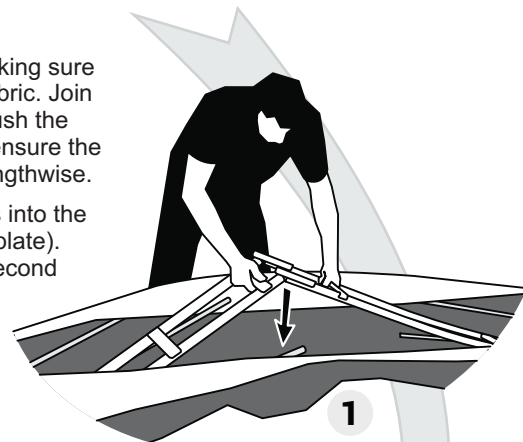

3.Assembly Instructions

Step 5

Repeat Step 2 to install short pole stringers. Then using the sliding latches, join all short pole stringers one by one to the long pole stringers, starting with the lower stringers. The upper stringers are to be locked last. To connect the stringers, raise the stringers slightly and slide the male latch connector part way into the female stringer. Slowly straighten the stringers whilst sliding the latch further inwards. To avoid damaging the skin, ensure that all the levers for the sliding latches are set at 90 degrees to the skin.

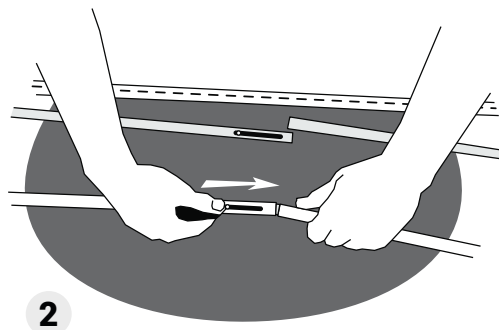
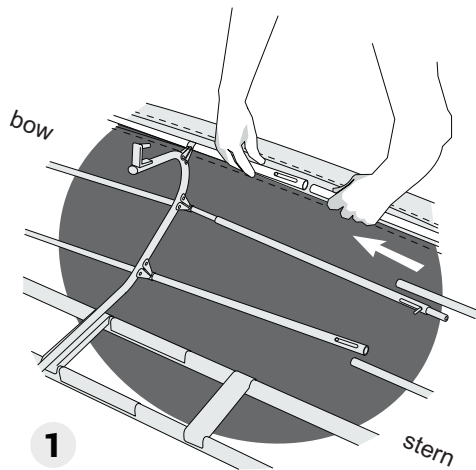

3.Assembly Instructions

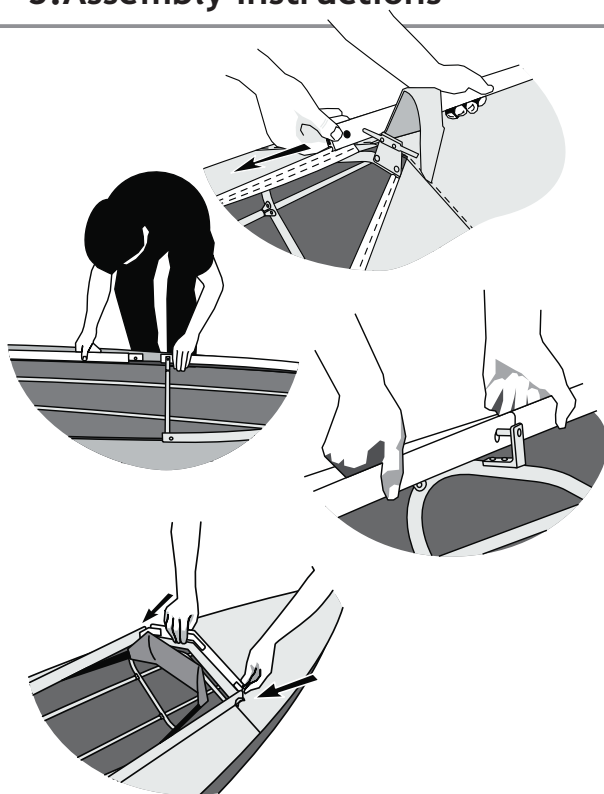

Step 6

Install the washboards. The right-hand washboard pieces have stamped numbers to match the numbers on the cross ribs (Velcro strips is the outside with the grooves being the bottom). Before installing the washboards remove all the wing nuts from the bolts on the Cross Ribs. Insert the grooved channel at the bottom of the washboard sections into the rounded edging on the skin. Slide the curved right-hand bow piece of the washboard from the front of the cockpit and rear right-hand piece via the rear end of the cockpit according to the numbered marks. Repeat with the left-hand side. Once the washboards have been joined in the centre, slip the washboards over the bolts of the Cross Ribs and secure loosely with the wing nuts. Make sure the first and last washboard holes are secured first, then the middle, last. Before you tighten the wing nuts, fit the rear cockpit boomerang piece in place. Then tighten the wing nuts securely (after the back rest/s have been fitted – see below), finishing with the wing nuts being in a horizontal position. This ensures that the spray deck can be fitted easily.

3.Assembly Instructions

Step 7

For the single seater set-up, secure the alu backrest bar for the seat back rest into the stern washboard holes. You will need to loosen and then re-tighten the cross-rib wing nuts to fit the back-rest bar into place. The seat straps are strapped to the D-rings on the kayak floor and Keel Bar. Inflate the foot rest, then secure using the straps between the Cross Rib #1 and D-rings on the kayak floor. Position of the foot rest can be regulated for your height.

When kayak is used as a two-seater — secure the second alu bar for the seat back rest into the holes in the bow washboards. The second seat and backrest bar are optional extra.

Now it's ready!

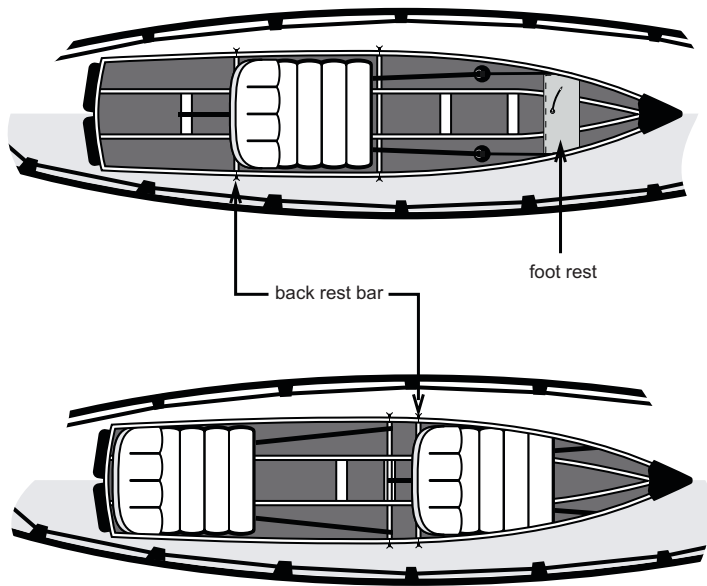

4. Additional Information

Unfolded kayak packaging

To ensure a long life of the folding kayak, correct packing is essential. When the skin is free of the frame, clean the skin of all mud, sand and vegetation, etc. If the kayak has been used on salty waters, the complete kayak must be rinsed off with fresh water. Spread the skin and dry out completely. Follow the steps on the diagram below to fold the skin and pack the Cross Ribs between the layers (Diagram 1 & 2). Place the folded skin into the bag. Place the seats, repair kit and other accessories such as spray deck and waist skirt on top of the skin. All Keel Bar parts and Bow and Stern Assembly is packed last.

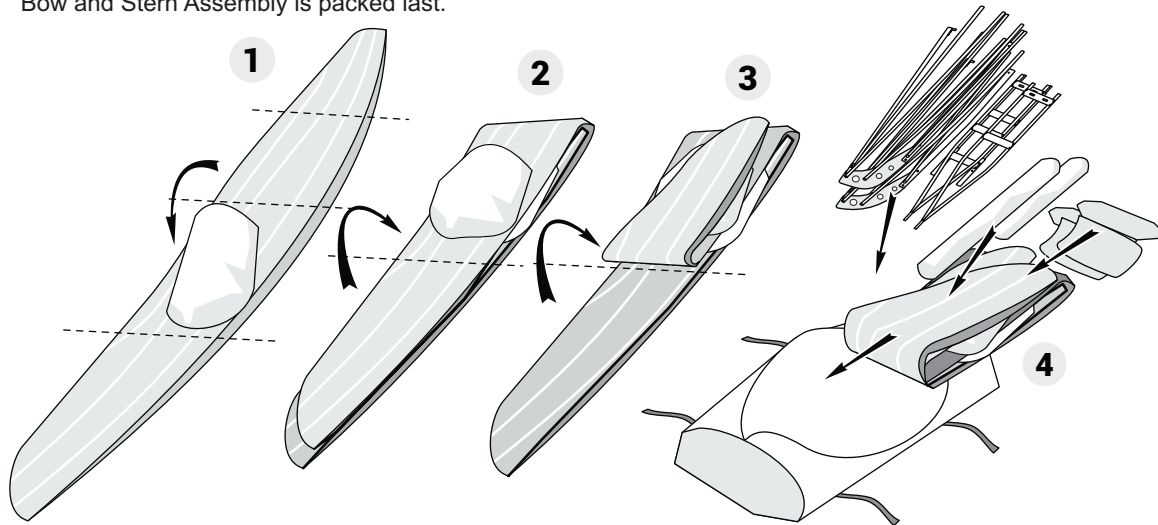

Storage and maintenance of the kayak

When the kayaking season is done, ensure that the Cross Ribs and Skin are completely dried out. It is recommended to store the kayak inside, in dry and warm conditions. This is a requirement for Cross Ribs mainly. The skin and other aluminium parts can be stored either on balconies or in a garage and/or locker. It is not recommended to unfold the skin whilst storing at very low temperatures. For longer life, the Cross Ribs can be varnished with a marine grade varnish at the end of the kayaking season. Follow instructions of the varnish manufacturer. Skin repair instructions can be found on line on the Neris website.

Manufacturer's Warrantee.NERIS LTD., the manufacturer, guarantees suitability and kayak material quality under the condition that the assembly and maintenance instructions has been followed. The manufacturing company will repair free within 36 months of use from the date of purchase should there be any manufacturer's defects. Any damage through incorrect assembly or from accidents will be at your own cost. You may attempt to do your own accidental repairs without affecting the warranty.

Contact us

Contact NERIS Ltd. for any suggestions and questions not revealed in this instructions manual.

Kayak Serial Number:

Date manufactured:

President of NERIS Ltd

..... Konstantin Abramov



NERIS Ltd ., 2 Bukaevitsa Street , Starye Pertovtsy Village
Vyshgorod District, Kiev Rigion, Ukraine
tel.: +3 044 229 28 88
website: www.neris kayaks.com
e- mail: info@neris kayaks.com

